

Ce document est le produit d'une numérisation par balayage de la publication originale.

This document was produced by scanning the original publication.

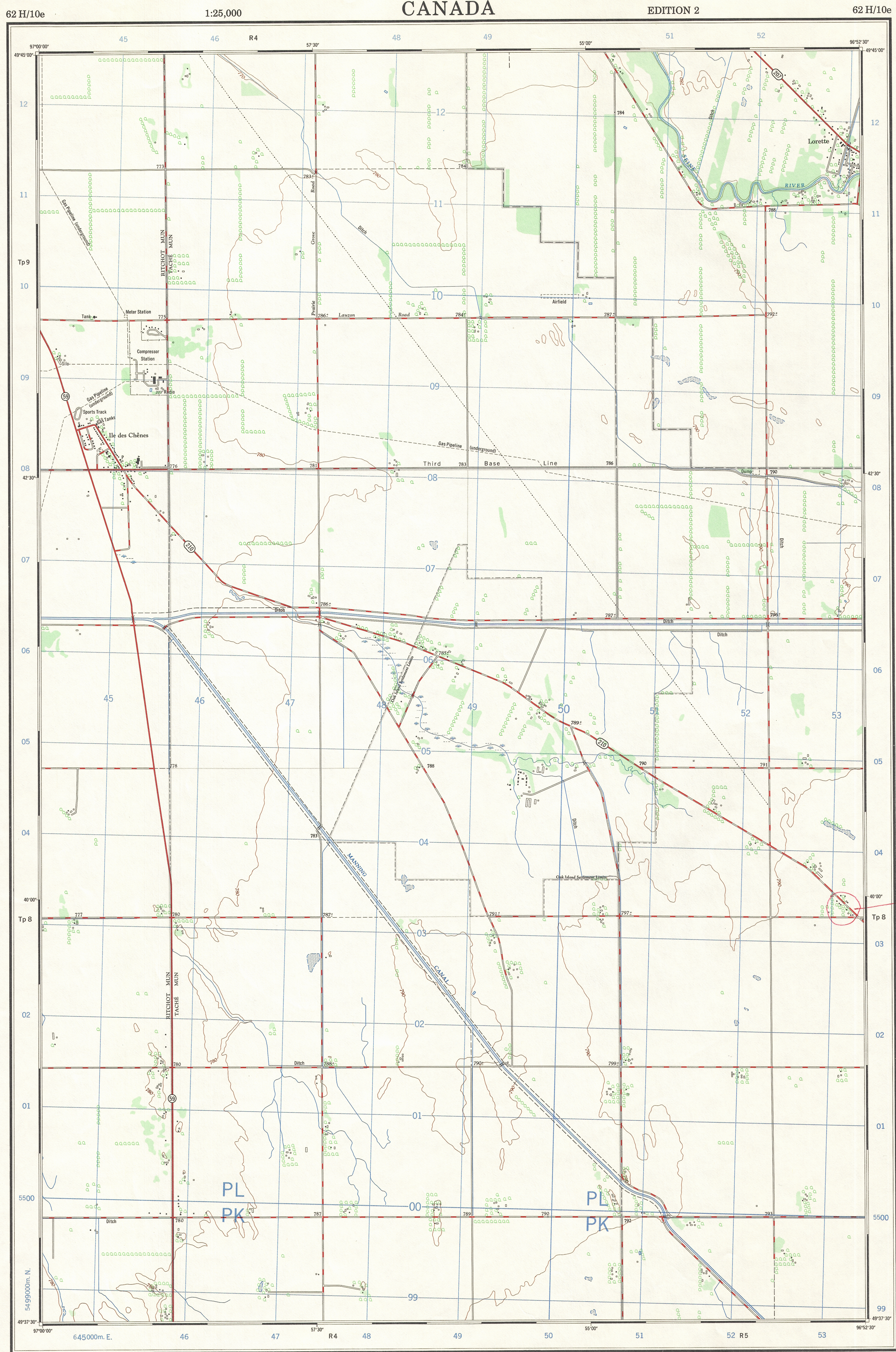

Refer to this map as: 62 H/10e EDITION 2 MCE SERIES A 841

CONVERSION SCALE FOR ELEVATIONS

Linden (Settl) 14-3-66 (62 H/10) A.C.

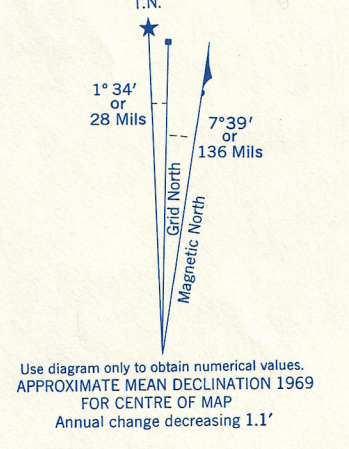

Use diagram only to obtain numerical values. APPROXIMATE MEAN DECLINATION 1969 FOR CENTRE OF MAP. Annual change decreasing 1.1°

| GRID ZONE DESIGNATION | 100,000 M. SQUARE IDENTIFICATION |
|-----------------------|----------------------------------|
| 14U | PK 55 |

| | |
|---|--------|
| TO GIVE A REFERENCE TO NEAREST 100 METRES | |
| EXAMPLE: | BRIDGE |
| EASTING: Read number on grid line immediately to left of point. Estimate tenths of a square from this line eastward to point. | 48 3 |
| NORTHING: Read number on grid line immediately below point. Estimate tenths of a square from this line northward to point. | 05 6 |
| MILITARY GRID REFERENCE | 483056 |
| Nearest similar grid reference 100,000 metres (about 63 miles) | |

ONE THOUSAND METRE UNIVERSAL TRANSVERSE MERCATOR GRID ZONE 14

First edition map updated by the SURVEYS AND MAPPING BRANCH, DEPARTMENT OF ENERGY, MINES AND RESOURCES. Information depicted current as of 1969. Printed 1970.

Copies may be obtained from the Map Distribution Office, Department of Energy, Mines and Resources, Ottawa.

See letter in booklet.

ILE DES CHÊNES MANITOBA

EAST OF PRINCIPAL MERIDIAN - EST DU MÉRIDIEN PRINCIPAL

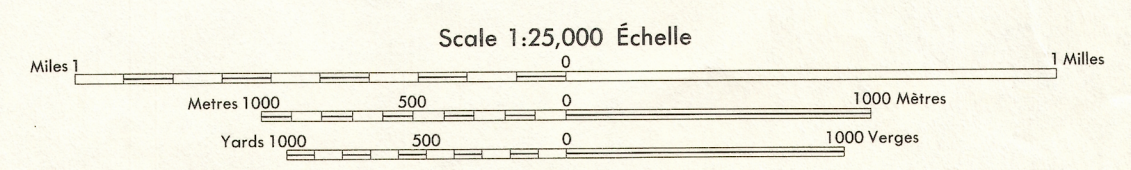

| | |
|--|--|
| Roads: | Routes: |
| hard surface, all weather | pavée, toute saison |
| hard surface, all weather | pavée, toute saison |
| loose or stabilized surface, all weather | gravier aggloméré, toute saison |
| loose surface, dry weather | de gravier, période sèche |
| cart track | de terre |
| trail or portage | sentier ou portage |
| Railway, normal gauge, single track | Chemin de fer, voie unique (écartement normal) |
| Horizontal control point, with elevation | Point géodésique, avec cote |
| Bench mark, with elevation | Repère de nivellement, avec cote |
| Spot elevation, precise | Point coté, précis |
| Mine or open cut | Mine ou fosse à ciel ouvert |

CONTOUR INTERVAL 10 FEET
Elevations in Feet above Mean Sea Level
North American Datum 1927
Transverse Mercator Projection

EQUIDISTANCE DES COURBES 10 PIEDS
Élévations en pieds au-dessus du niveau moyen de la mer
Système de référence géodésique nord-américain, 1927
Projection transverse de Mercator

| | | | |
|-------------------------------|----------------------------------|------------------|-------------------|
| Building | Bâtiment | Church | Église |
| School | École | Post Office | Bureau de poste |
| Cemetery | Cimetière | Navigation Light | Feu de navigation |
| Rock, bare or awash | Roche, nue ou à fleur d'eau | | |
| Power transmission line | Ligne de transport d'énergie | | |
| River with bridge | Rivière avec pont | | |
| Rapids, Falls, large small | Rapides, Chutes, grands, petits | | |
| Lake intermittent, indefinite | Lac intermittent, rive imprécise | | |
| Marsh or Swamp | Marais ou marécage | | |
| Depression contours | Courbes de cuvette | | |
| Trees | Arbres | | |
| Woods | Bois | | |
| Vineyard, Orchard | Vignoble, Verger | | |

TABLEAU D'ASSEMBLAGE DU SYSTÈME NATIONAL DE RÉFÉRENCE CARTOGRAPHIQUE

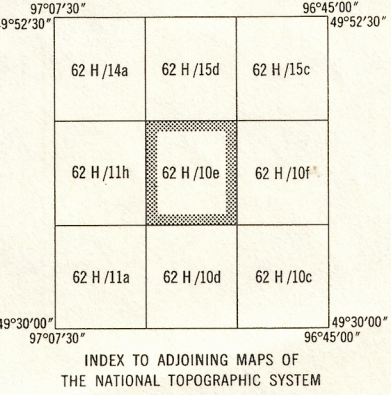

INDEX TO ADDING MAPS OF THE NATIONAL TOPOGRAPHIC SYSTEM

ILE DES CHÊNES
62 H/10e
EDITION 2