

This document was produced
by scanning the original publication.
Ce document est le produit d'une
numérisation par balayage
de la publication originale.

13-I

1:250,000

CANADA

EDITION 1

13-I

Refer to
this map as:
13-I
EDITION 1 MCE
SERIES A 501



deleted at 1000M/1
15-06-80
MFD

GRID ZONE DESIGNATION		100,000 M. SQUARE IDENTIFICATION	
21 U	<div><div>VLWL</div><div>VKWK</div><div>5</div></div>		60
TO GIVE A REFERENCE TO NEAREST 1000 METRES			
EXAMPLE: LIGHTHOUSE			
SQUARE: Read letters of 100,000 m. square W.L.			0
EASTING: Read number on grid line immediately to left of point			7
Estimate tenths of a square from this line eastward to point.			07
NORTHING: Read number on grid line immediately below point			3
Estimate tenths of a square from this line northward to point.			34
MILITARY GRID REFERENCE (to nearest 1,000 metres)			WL 0734
If reporting beyond 18° in any direction, prefix Grid Zone Designation as: 21UW L0734			
TEN THOUSAND METRE UNIVERSAL TRANSVERSE MERCATOR GRID ZONE 21			

RELIABILITY DIAGRAM - CROQUIS D'EXACTITUDE

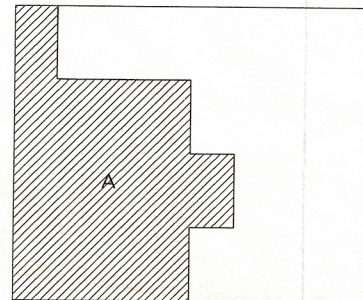

A. Large scale maps, photogrammetric, from aerial photographs taken in 1953.

A. Cartes à grande échelle, photogrammétriques d'après des photographies aériennes prises en 1953.

Derived, 1964, by the SURVEYS AND MAPPING BRANCH,
DEPARTMENT OF ENERGY, MINES AND RESOURCES.
Printed 1966

Magnetic declination 1968 varies from 33°32' westerly at
centre of west edge to 33°35' westerly at centre of east
edge. Mean annual change 4.7' easterly.

GROSWATER BAY
NEWFOUNDLAND

Scale 1:250,000 Échelle

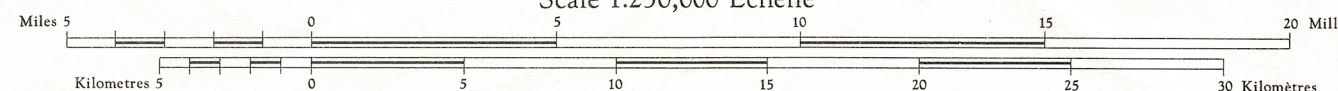

Transverse Mercator Projection
North American Datum 1927
Contours interval 100 feet
Elevations in feet above Mean Sea Level

Copies may be obtained from the Map Distribution Office,
Department of Energy, Mines and Resources, Ottawa.

Projection Transverse de Mercator
Niveau de référence nord-américain 1927
Équidistance des courbes 100 pieds
Élévations en pieds au-dessus du niveau moyen de la mer

Ces cartes sont en vente au Bureau de distribution des cartes,
ministère de l'Énergie, des Mines et des Ressources, Ottawa.

Établie en 1964, par la DIRECTION DES LEVÉS ET DE LA CARTOGRAPHIE,
MINISTÈRE DE L'ÉNERGIE, DES MINES ET DES RESSOURCES. Imprimée
en 1966.

La déclinaison magnétique pour 1968 varie de 33°12' Ouest
au centre de la limite Ouest à 33°35' Ouest au centre de la
limite Est. Variation moyenne annuelle 4,7' Est.

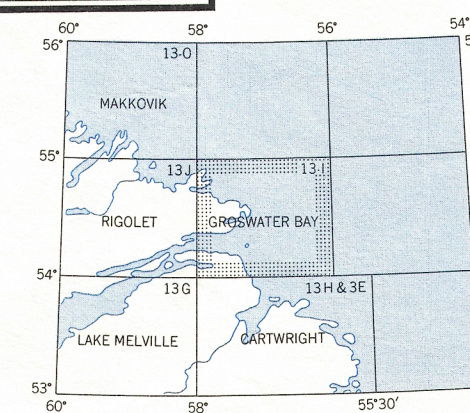

Index to adjoining maps of National Topographic System
Tableau d'assemblage du Système national de référence cartographique

GROSWATER BAY
13-I
EDITION 1

REPRINT
JULY 69

13-I