

**Canada**  
**DEPARTMENT OF MINES**  
**MINES BRANCH**

HON. ROBERT ROGERS, MINISTER; A.P. LOW, LL.D., DEPUTY MINISTER  
 EUGENE HAANEL, PH.D., DIRECTOR

MAGNETOMETRIC MAP

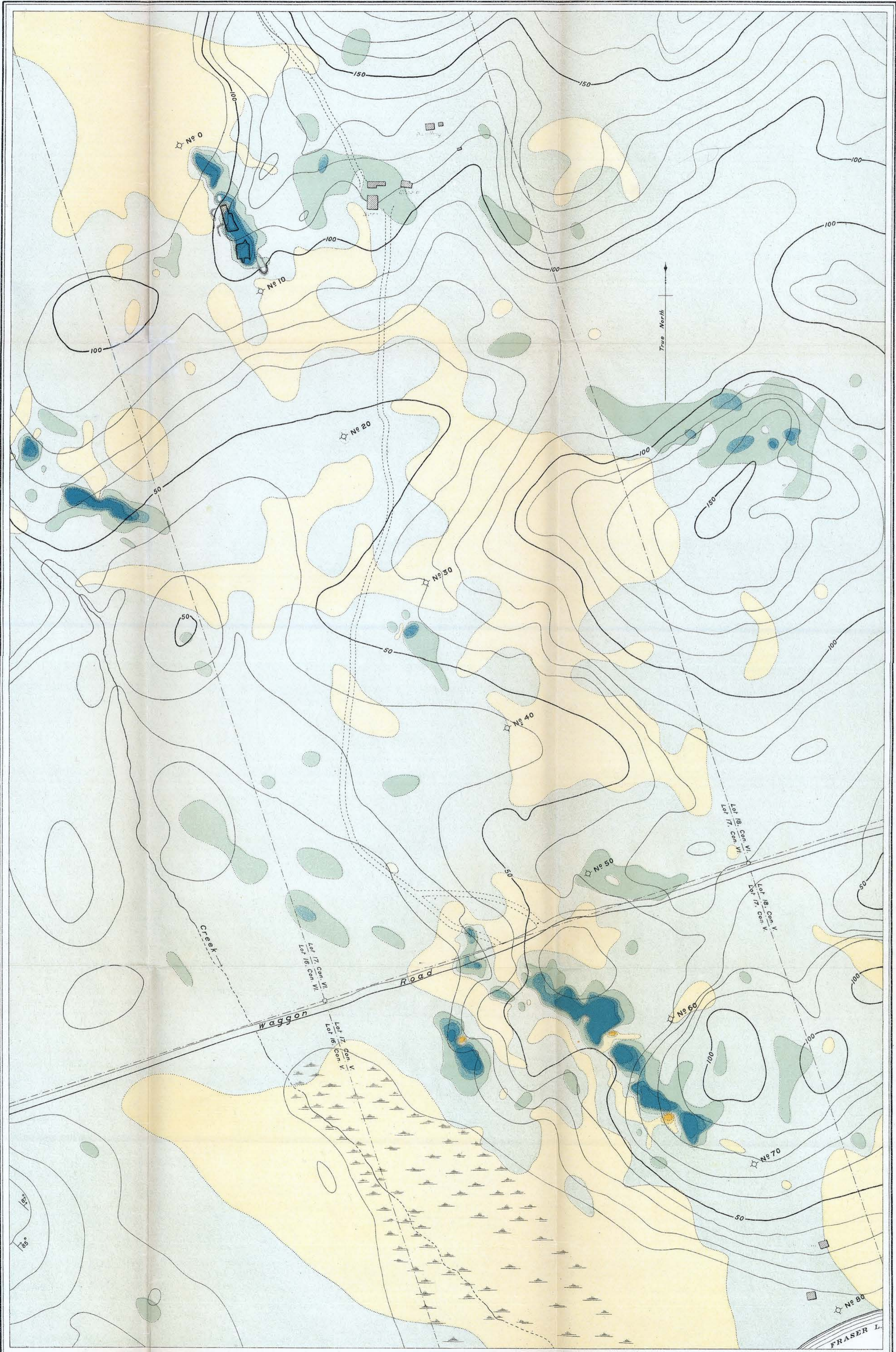

**LEGEND**

Isodynamic lines of the vertical magnetic intensity

**Positive Intensity**

	Magnetic attraction greater than 60°
	between 50° - 60°
	" 40° - 50°
	" 20° - 40°
	" 0° - 20°

**Negative Intensity**

	between 0° - -20°
	" -20° - -40°
	" -40° - -50°

Constant of Instrument = 1.0 H  
 Magnetic declination about 9° West

LE, buildings  
 Corned Lot lines  
 Cor posts anes

**LEGEND**

- Roads and buildings
- Corner posts and Lot lines
- Reference posts
- Strippings
- Swamp
- Contours, interval 10 feet  
Elevations above level of Fraser Lake
- Mine dumps
- Swamp

H. E. Baine, Chief Draughtsman  
 L. H. S. Pereira, Draughtsman

**IRON ORE DEPOSITS**  
 LOTS 16, 17, 18, CON. V AND VI  
 CARLOW TOWNSHIP  
 ONTARIO

Scale 1:200 = 200' to 1 Inch

Surveyed by  
 E. Lindeman 1911  
 Assisted by W. M. Morrison

NO. 193