

Canada
DEPARTMENT OF MINES
MINES BRANCH

HON. ROBERT ROGERS, MINISTER; A. P. LOW, LL.D., DEPUTY MINISTER
EUGENE HAANEL, PH.D., DIRECTOR

MAGNETOMETRIC MAP

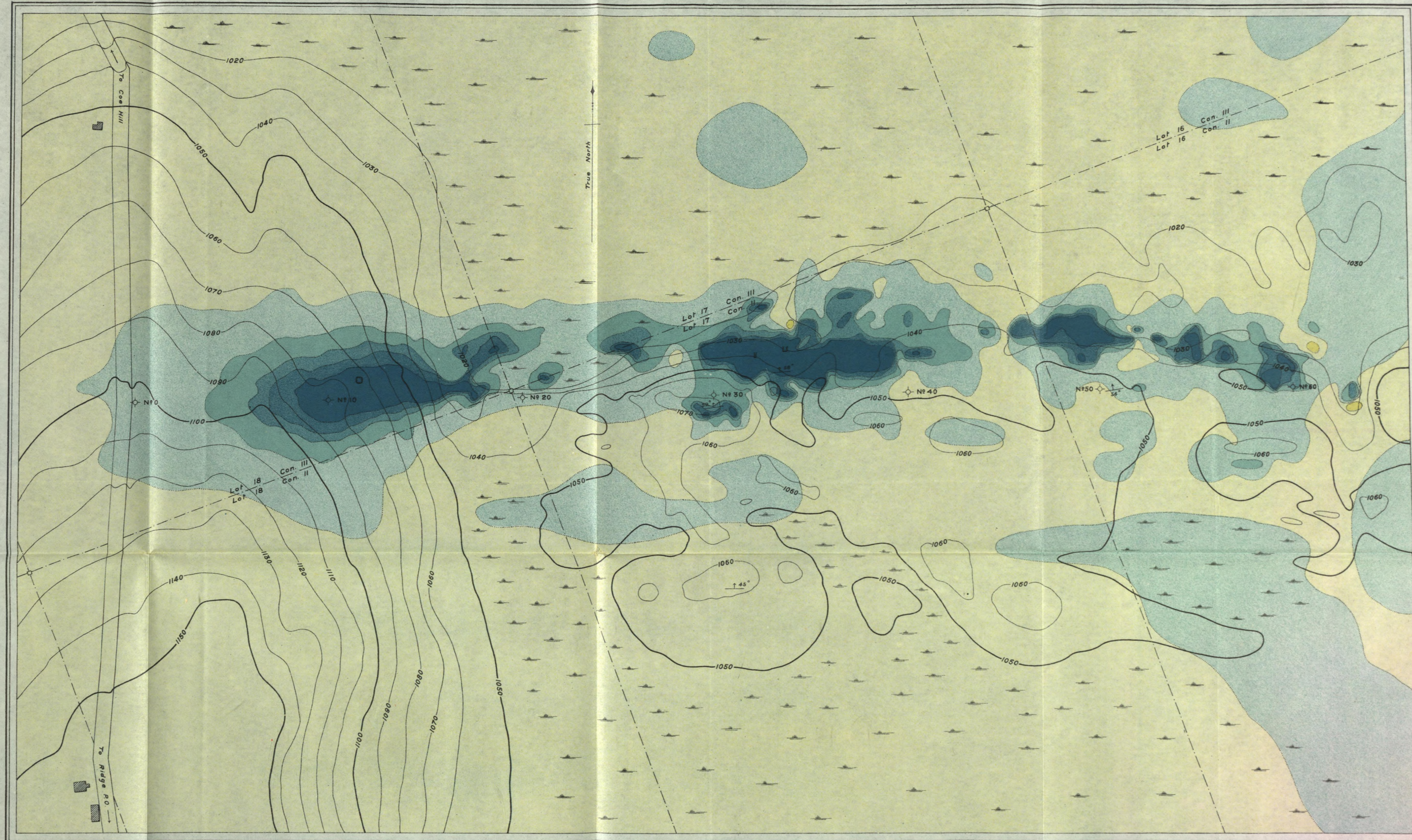

H. E. Baine, Chief Draughtsman
L. H. S. Pereira, Draughtsman

RIDGE IRON ORE DEPOSITS
LOTS 17 AND 18, CON. III, AND LOTS 16 AND 17, CON. II
TOWNSHIP OF WOLLASTON
HASTINGS COUNTY
ONTARIO
Scale 1:200 to 1 inch

Surveyed by
E. Lindeman 1911
Assisted by O. G. Gallaher

NO. 189