

# INTERNATIONAL BOUNDARY

FROM THE ST. LAWRENCE RIVER  
TO THE SOURCE OF THE ST. CROIX RIVER

SHEET No. 60

SURVEYED UNDER THE DIRECTION OF  
UNITED STATES COMMISSIONER HIS BRITANNIC MAJESTY'S COMMISSIONER  
O. H. TITTMANN, 1908-1916 W. F. KING, 1908-1916  
E. C. BARNARD, 1915-1921 J. J. McARTHUR, 1917-  
E. LESTER JONES, 1921  
IN ACCORDANCE WITH ARTICLE III OF THE TREATY OF 1808.

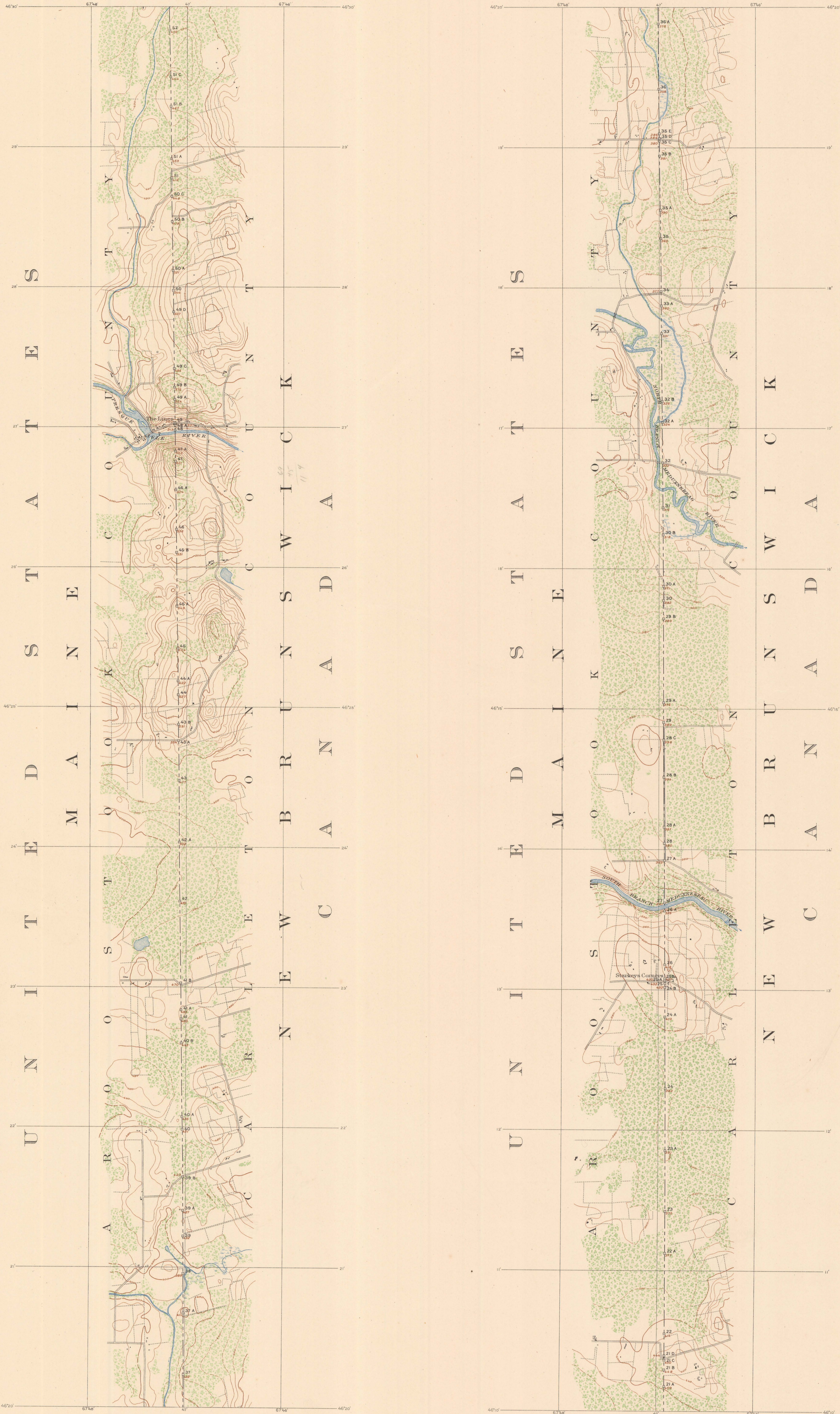
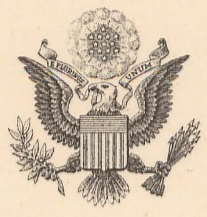

FOR HIS MAJESTY  
SURVEYOR IN CHARGE: G. C. RAINBOTH, D. L. S., 1908  
CONTROL BY: M. F. COCHRANE, 1908, AND J. L. BARKER,  
D. T. S., 1916  
TOPOGRAPHY BY: G. L. RAINBOTH, I. R. POUNDER, AND  
C. R. WESTLAND, 1908  
MONUMENTING BY: G. C. RAINBOTH, D. L. S., 1908  
INSPECTION BY: G. C. RAINBOTH, D. L. S., 1908

FOR THE UNITED STATES  
SURVEYOR IN CHARGE: J. B. BAYLOR, 1908  
CONTROL BY: R. H. BLAIR AND J. LOCKE, 1908  
MONUMENTING BY: J. B. BAYLOR, 1908  
INSPECTION BY: J. B. BAYLOR, 1908

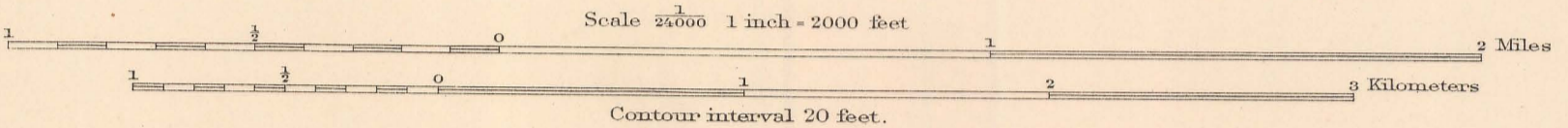

Scale 1 inch = 2000 feet  
1:2000  
0 1 2 Miles  
0 1 2 Kilometers  
Contour interval 20 feet.  
Distances in miles and feet.  
Dotted line indicates that the elevations on this sheet are 6 feet too low.

International Boundary Line  
Boundary Monuments  
Timbered Avenues  
Deciduous  
Evergreen

We certify that this map is one of the quadruplicate set of sixty-one (61) maps adopted under Article III of the Treaty between Great Britain and the United States, signed at Washington April 11, 1908, and that we have marked thereon the Boundary Line as re-established by the Commissioners designated above, in accordance with the provisions of the said Article.

Signed July 17, 1923.  
W. F. King  
His Britannic Majesty's Commissioner  
E. Lester Jones  
United States Commissioner