

WARDEN TOWNSHIP

DISTRICT OF COCHRANE, ONTARIO

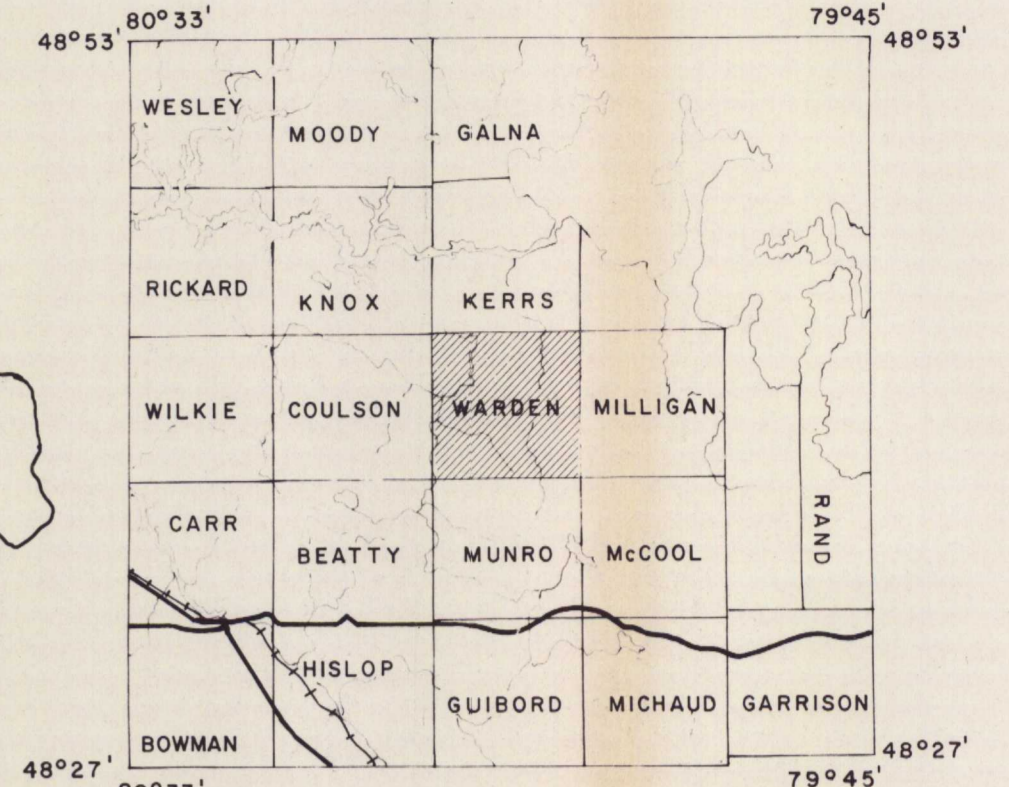
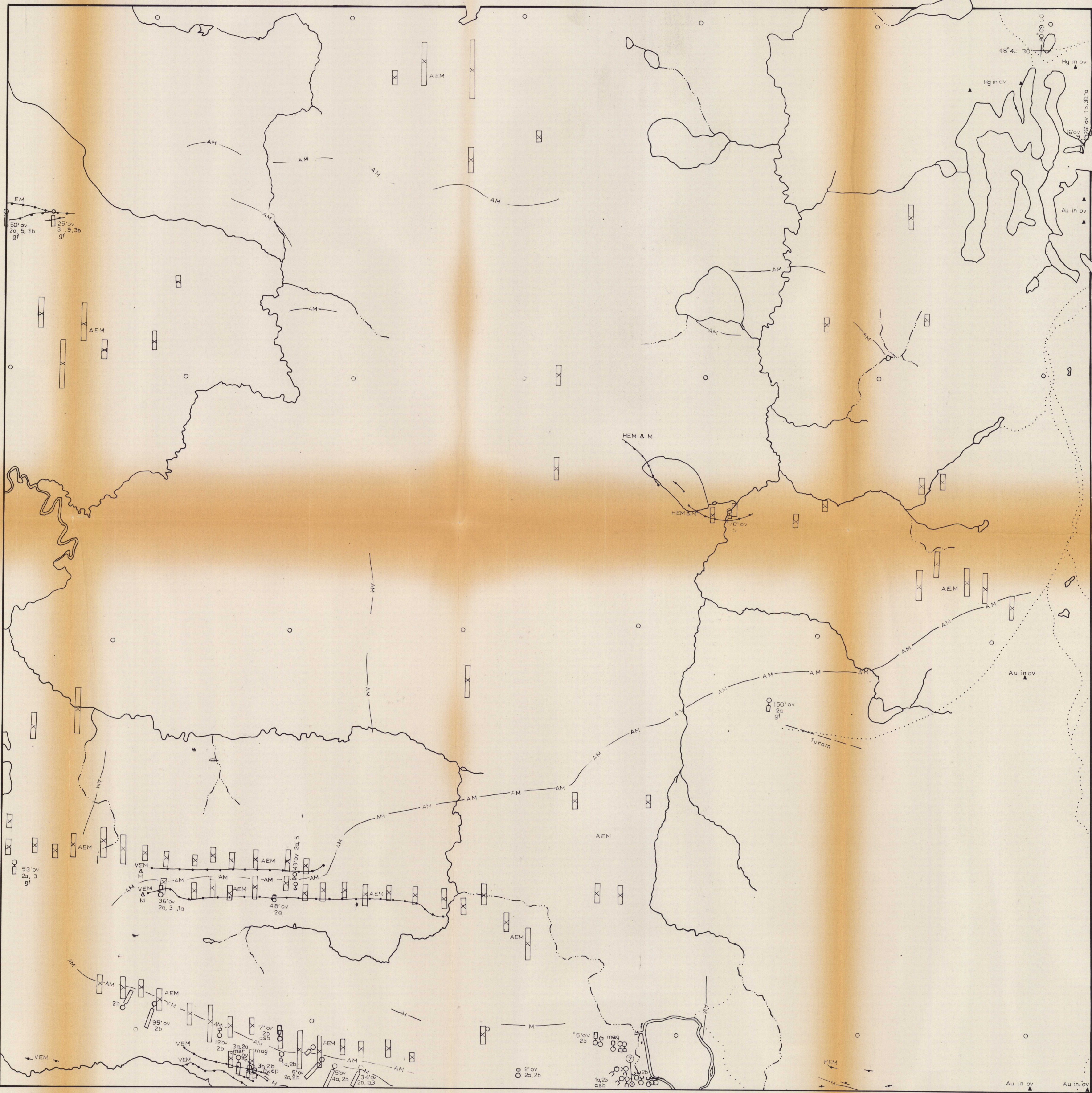
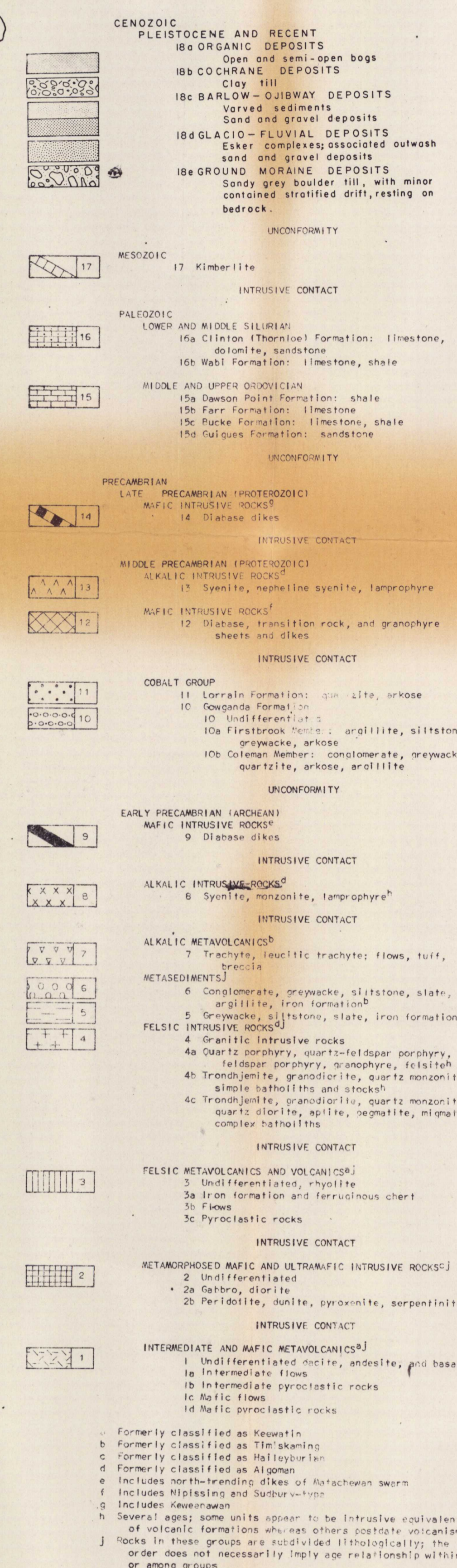

TABLE OF LITHOLOGICAL UNITS  
KIRKLAND LAKE DATA SERIES



Scale: 1 inch to 1/4 mile

DATA FILED WITH THE  
 ONTARIO DEPARTMENT OF MINES  
 AND NORTHERN AFFAIRS  
 RESIDENT GEOLOGIST  
 AT KIRKLAND LAKE  
 (THROUGH DECEMBER 1971)

	GEO. OS. CAL.	DIAMOND DRILLING	AIRBORNE MAGNETOMETER	AIRBORNE ELECTROMAGNETOMETER	GROUND MAGNETOMETER	VERTICAL LOOP ELECTROMAGNETOMETER	HORIZONTAL LOOP ELECTROMAGNETOMETER	TURAM ELECTROMAGNETOMETER	JEM	INDUCED POLARIZATION	VLF	RESISTIVITY	GRAVITY	GEOCHEMICAL	OTHER
1. Area Mines Ltd.		55/64													
2. Broulan Reef Mines Ltd.		59													
3. Canadian Johns-Manville "North Ford"					63	70	63								
4. Canadian Johns-Manville "Potter claims"					64										
5. Canadian Johns-Manville "Masters Group"		64			64										
6. Dymal Prospecting & Syndicate		51													
7. Hedman Mines Ltd.		608													
8. Hoyle Mines Co. Ltd.		64			64										
9. Kenneco Exploration Canada Ltd.		64		64	64					64					
10. Kenneco Exploration Canada Ltd. "Hanson option"		64													
11. McIntyre Porcupine Mines Ltd.					45										
12. Respl Mines Ltd.		50					61								
13. Paymaster Consolidated Mines Ltd.		40													
14. Skanner, H.															
15. Stairs, Ivan C.															
16. Union Carbide Explorations Ltd.				64	62		62								

\* (1) Hedman Mines Ltd.: Drilled 33 holes in 1960 in a 300 x 1400-foot area in 100' separations. Assessment work was submitted only for 12 holes. 400' serpentinized andesite, tuffaceous with asbestos fibre (chrysotile).

Note: The numbers on the above list stand for the year when the work was done; e.g., 66 for 1966. On the accompanying DATA LOCATION MAP, only areas for which work was submitted to the Department are outlined, and thus a company may hold more ground than indicated here. The numbers on the DATA LOCATION MAP and any circled numbers refer to the company list above.

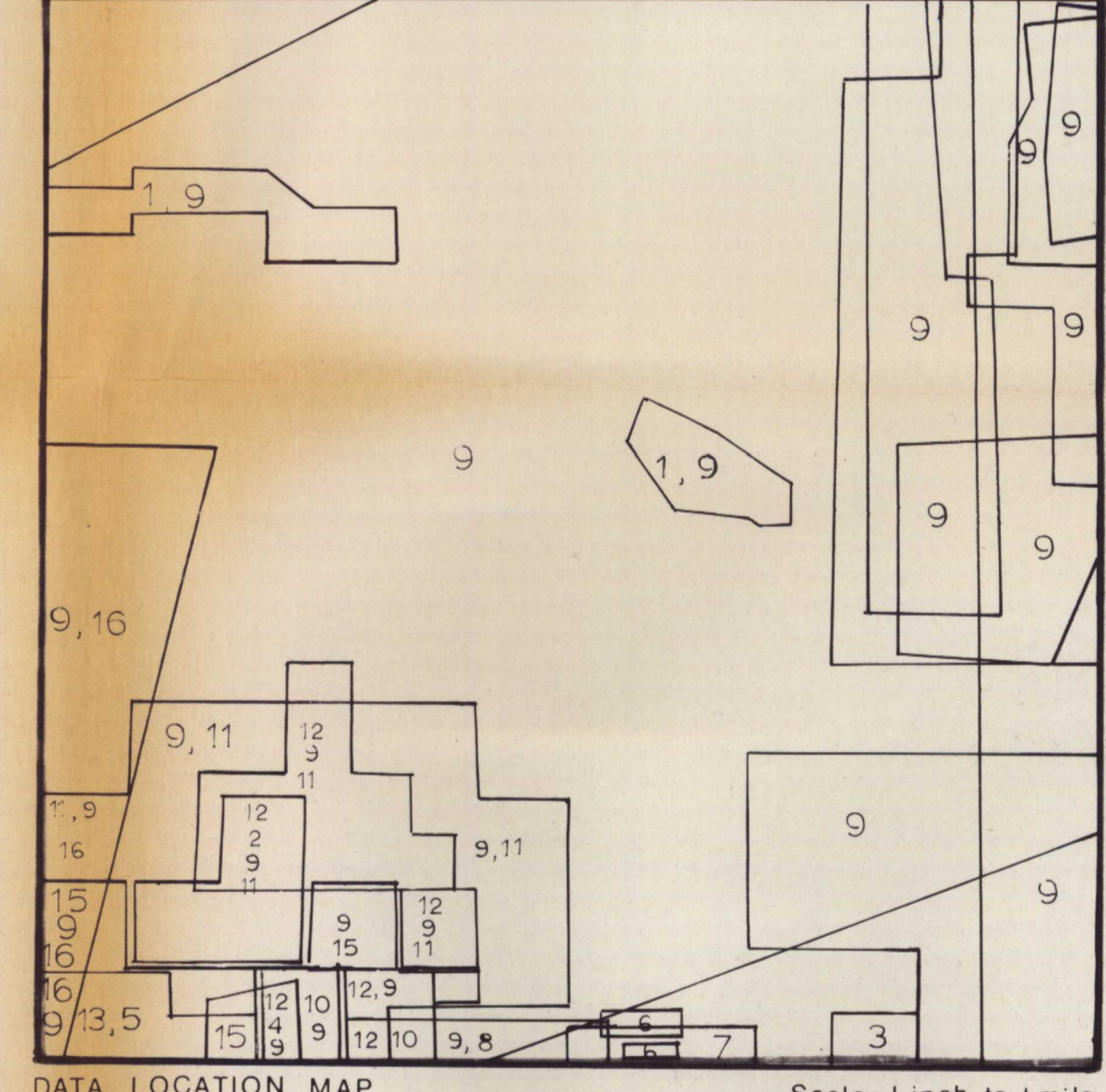
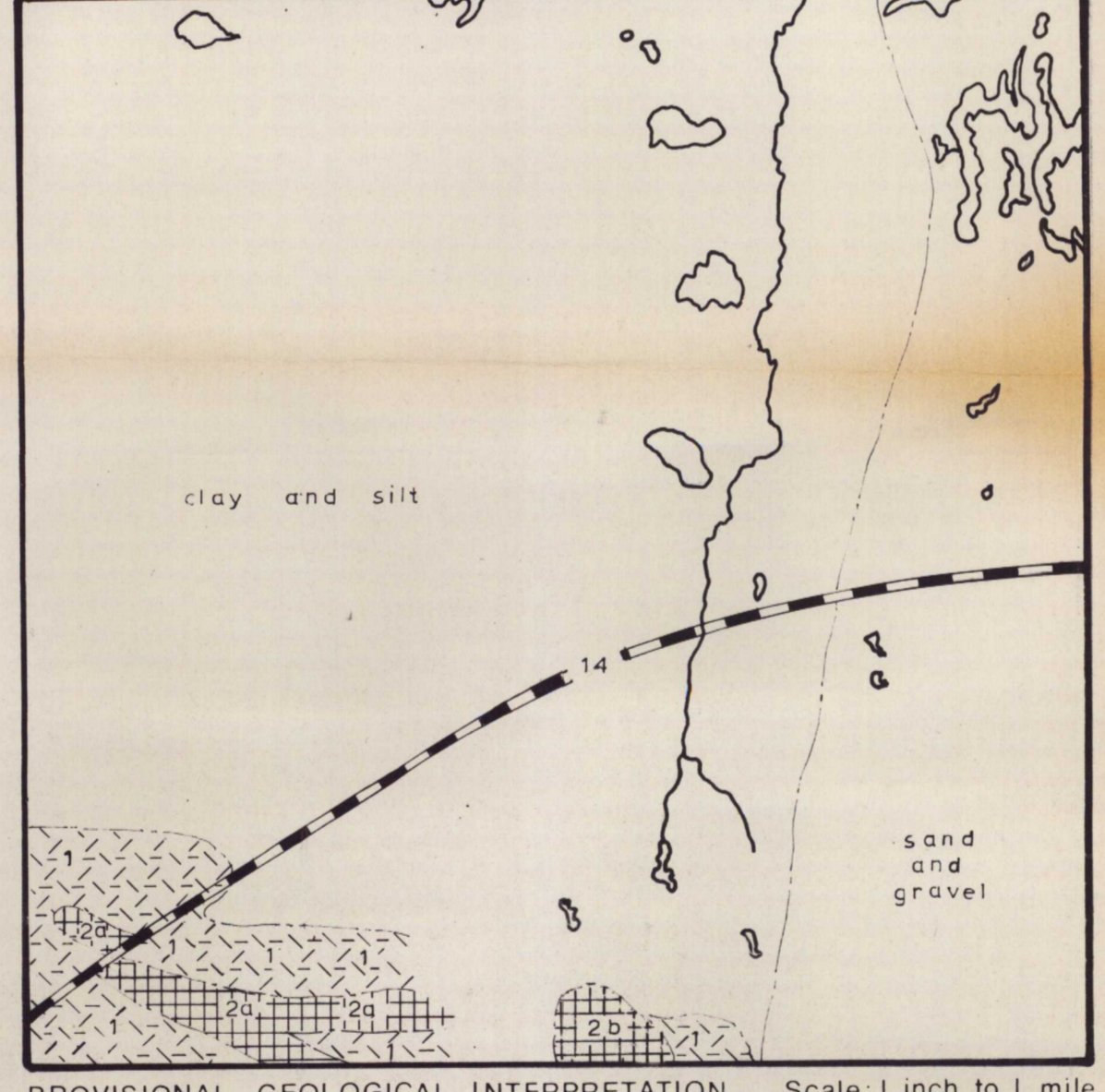

GEOLOGICAL AND MINING SYMBOLS FOR KIRKLAND LAKE DATA SERIES

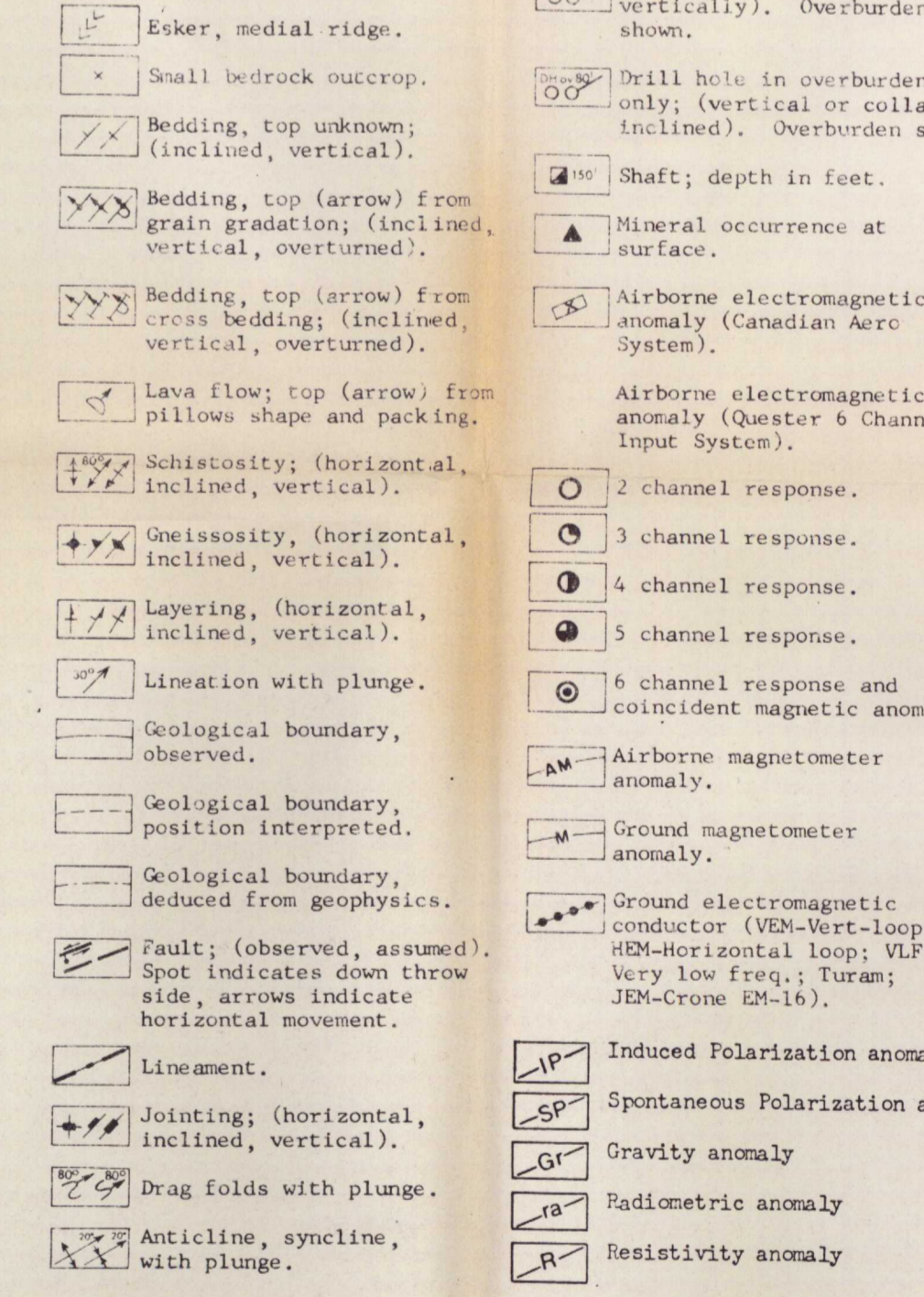

METAL AND MINERAL REFERENCE

For Kirkland Lake Data Series

Ag	Silver	Mo	Molybdenite
As	Asbestos	Ni	Nickel
Au	Gold	Pb	Lead
Cd	Cadmium	Pt	Palladium
Co	Cobalt	Py	Pyrrhotite
Cu	Chalcopyrite	Sp	Spinel
Cz	Chromite	Tl	Tellurite
Fe	Iron	U	Uranium
Fl	Fluorite	V	Vanadium
Ga	Galenite	W	Wolframite
Gr	Graphite	X	Other
Mg	Magnetite		
Mn	Marcasite		
Mi	Millerite		

Sources of Information

Compiled by the Geological Survey of Canada in co-operation with the Ontario Department of Mines and Northern Affairs from data on file with the Resident Geologist (Ontario Department of Mines and Northern Affairs), Kirkland Lake.

NTS Reference L2 A/9  
 OM-55 Aeromagnetic Map 2960  
 OM Geological Contour Series Map 206  
 OMNA Total Intensity Aeromagnetic Map P.42  
 OMNA Total Count Helicopter Gamma Ray Spectrometer Map P.42  
 OMNA Aerial Photography Helicopter E-Phase Map P.42  
 OMNA Aerial Infrared Helicopter Radiophase Map P.42  
 OSC Surficial Geology Map 44-1995

OPEN FILE  
 84  
 MAR 1972  
 GEOLOGICAL SURVEY  
 OTTAWA