

enclure 28"

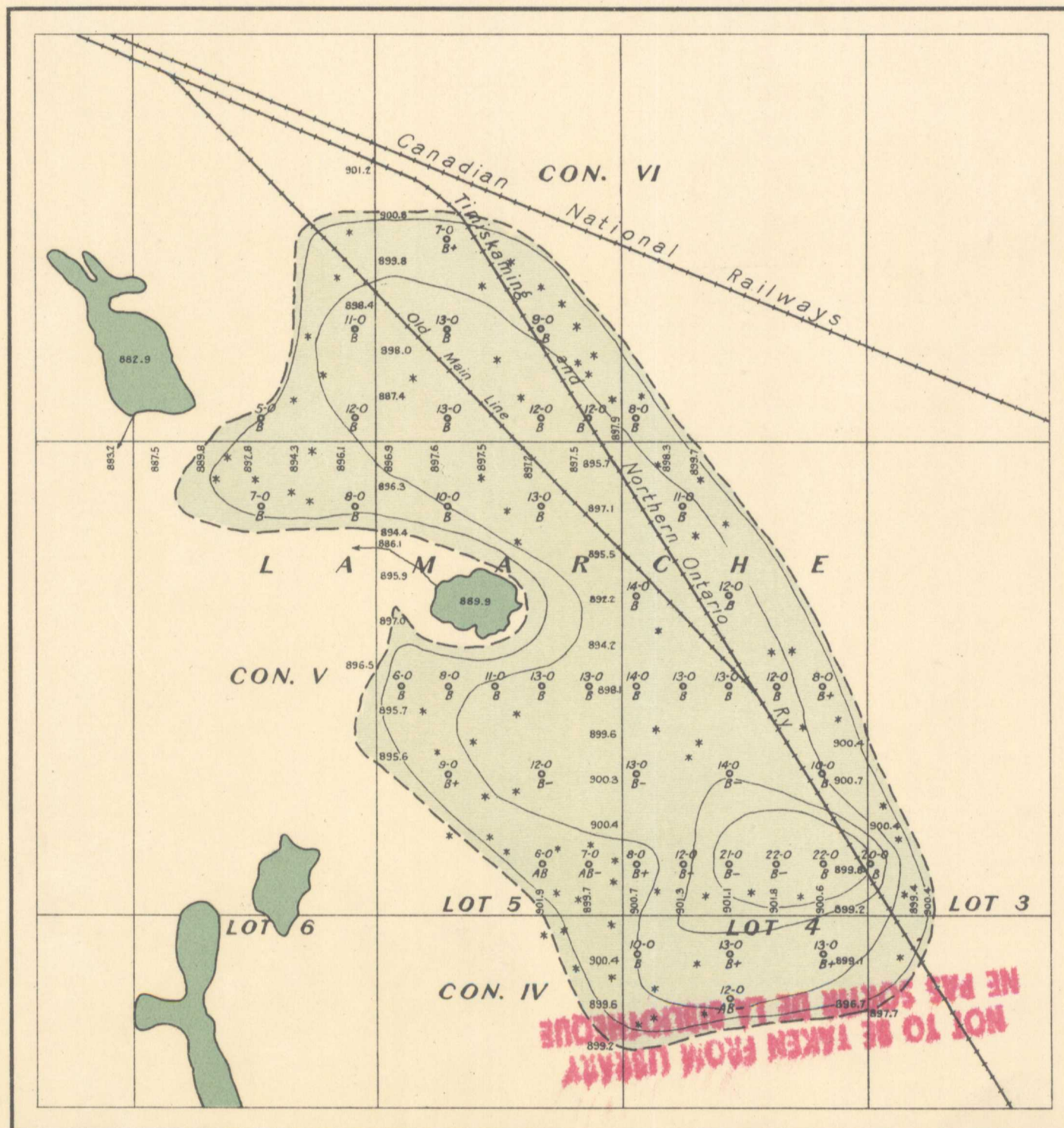

Legend

Water areas

Peat bog

Margin of bog

Contours of bottom of bog
(lines show depth below surface)

Drill-holes
(with thickness of peat shown in feet and inches)

Peat classification symbols

Wooded areas

Elevations
(T. and N.O. Railway datum)

Classification of Peat

- | | | |
|---|------------------------|-------------------------------------|
| Peat more or less suitable for the manufacture of peat fuel | A | } highly humified; good |
| | A- | |
| | AB+ | } well humified |
| | AB | |
| AB- | } fairly well humified | |
| B+ | | |
| Peat more or less suitable for the manufacture of peat litter | B | } less well humified; poor |
| | B- | |
| | BC+ | } slightly humified; poor |
| BC | | |
| Peat more or less suitable for the manufacture of peat litter | BC | } fairly free from humus |
| | C+ | |
| | C | } practically free from humus; good |
| C- | | |

Geological Survey, Canada.

Publication No. 1891

Cochrane Peat Bog, Lamarche township, Timiskaming district, Ontario.

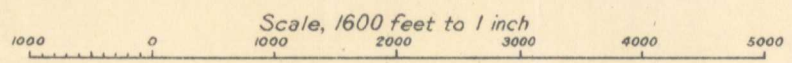

5.1.7
A, Geol.

To accompany Memoir by A. Anrep

Peat surveys by A. Anrep, 1917

1891

This map has been produced from a scanned version of the original map
Reproduction par numérisation d'une carte sur papier