

Intend this edge to 28"

GEOLOGICAL SURVEY OF CANADA
1898

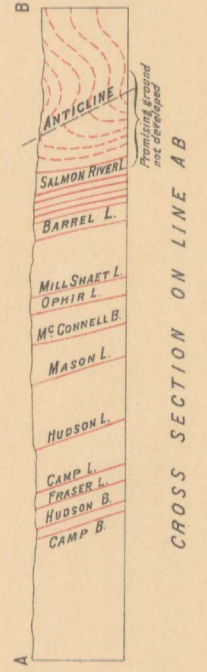

PLAN AND SECTION
FOREST HILL GOLD DISTRICT, GUYSBOROUGH CO., N.S.

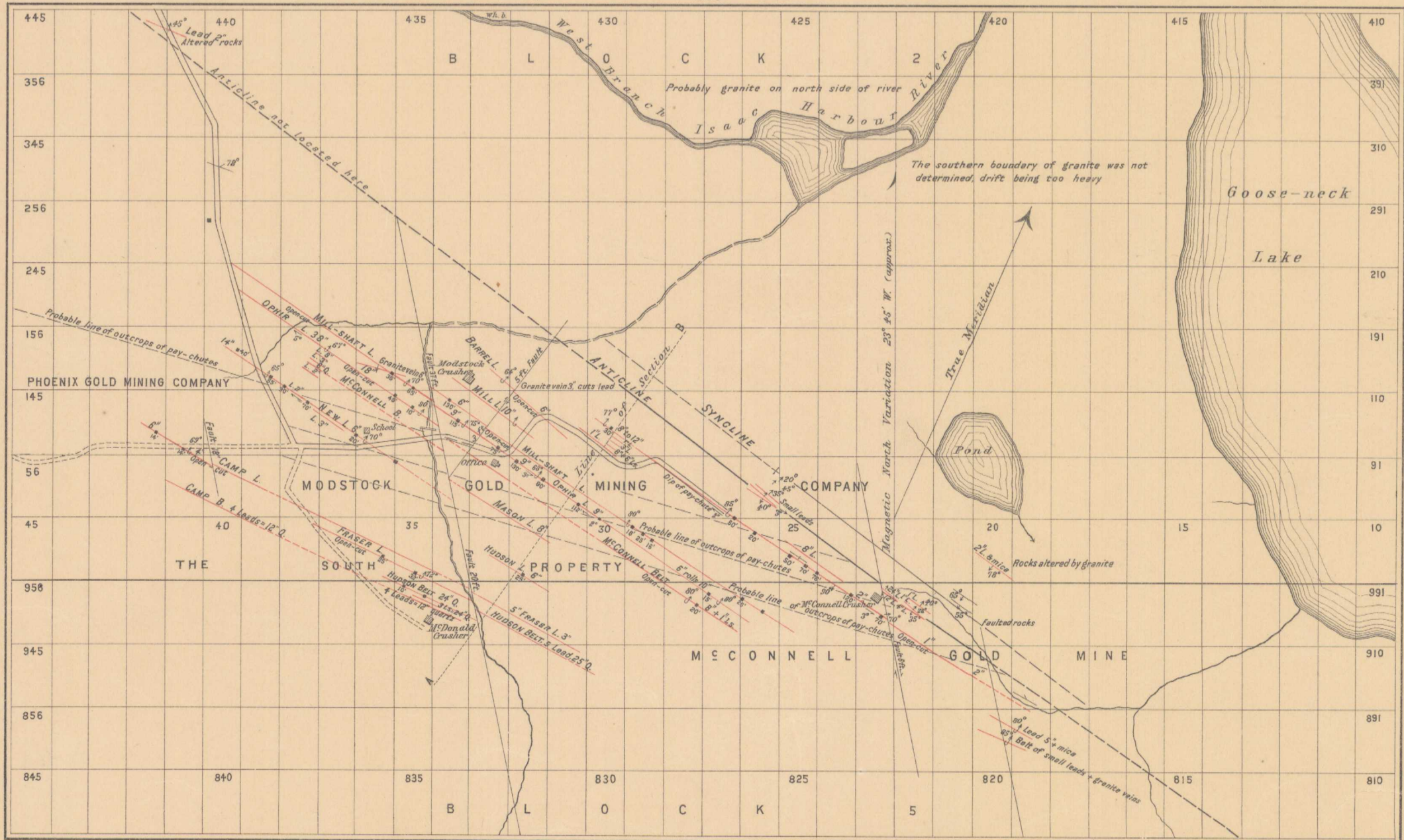

Surveyed by E.R. Foribault B.A.Sc.

Forest Hill
5.1.6
A, PD

NOT TO BE TAKEN FROM LIBRARY
NE PAS SORTIR DE LA BIBLIOTHÈQUE

649

649

1898

This map has been produced from a scanned version of the original map
Reproduction par numérisation d'une carte sur papier