

PLAN AND SECTION
FIFTEEN-MILE STREAM GOLD DISTRICT
HALIFAX COUNTY, N. S.

Scale 500 Feet to 1 inch
0 100 200 300 400 500 Feet

Fifteen-mile stream

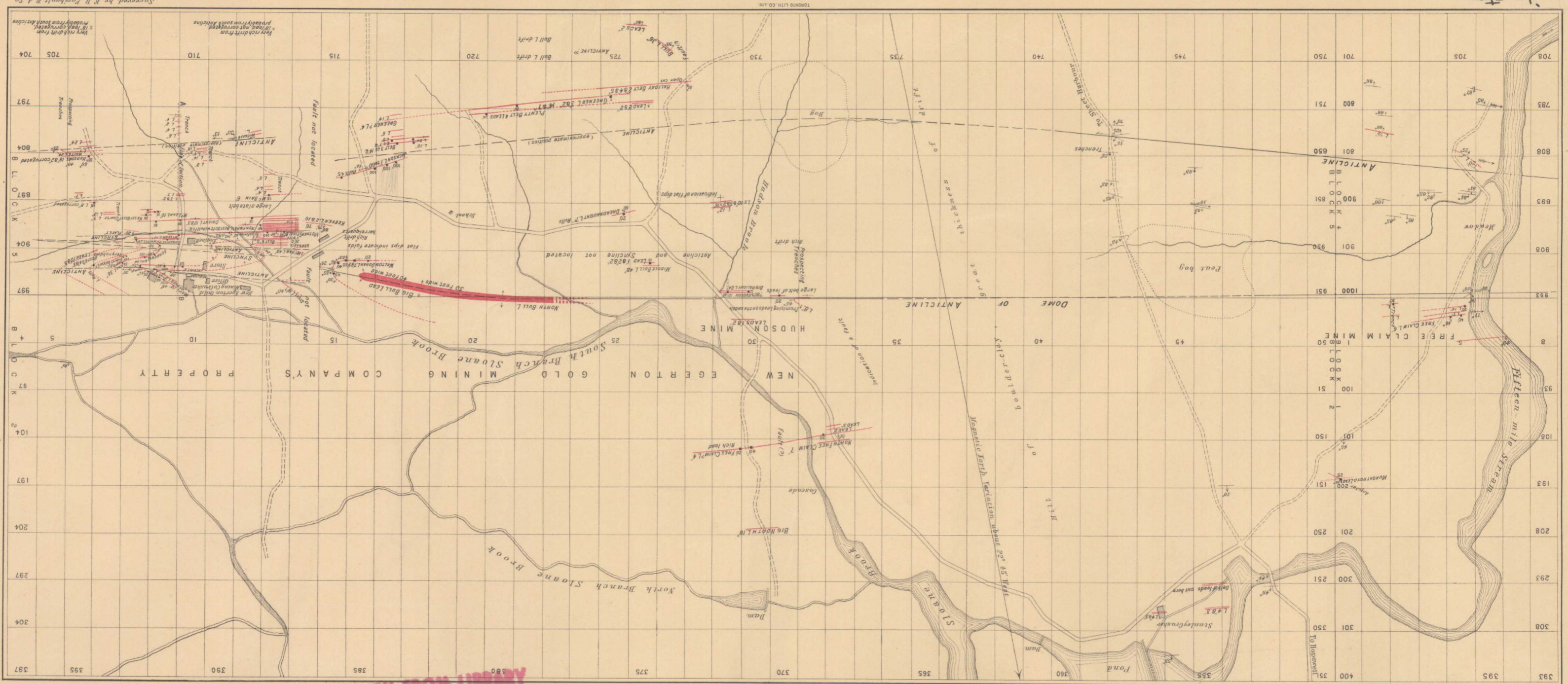

Surveyed by E. H. Forbault B. A. Sc.

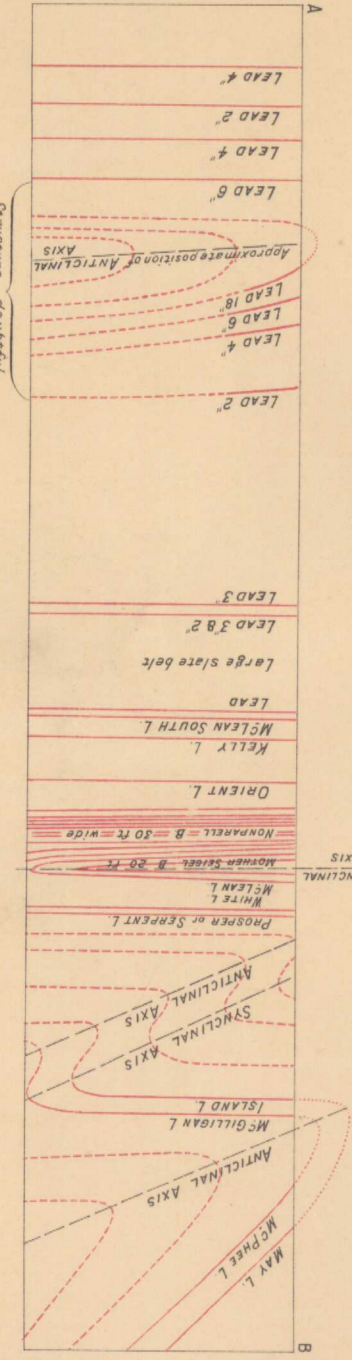

CROSS SECTION ON LINE A-B
Scale 150 Feet to 1 inch

NOT TO BE TAKEN FROM LIBRARY
NE PAS SORTIR DE LA BIBLIOTHÈQUE

1889
GEOLOGICAL SURVEY OF CANADA

This map has been produced from a scanned version of the original map
Reproduction par numérisation d'une carte sur papier