

Canada Department of Mines

HON. SIR JAMES A. LOUGHEED, MINISTER; CHARLES CAMSELL, ACTING DEPUTY MINISTER.

GEOLOGICAL SURVEY
WILLIAM McINNES, DIRECTOR.

Issued 1920

LEGEND

GLACIAL	Q	Boulders, gravel, and sand	— — — — —	Geological boundary
	4	Molybdenite bearing pyroxenite	/ 60°	Dip and strike
	3	Pegmatite	\ 60°	Dip and strike, foliation
	2	Hornblende syenite	▨ ▨ ▨ ▨	Roads and buildings
	1	Diorite	= = = = =	Roads (not well defined)
EARLY PRECAMBRIAN QUATERNARY	AI	Crystalline limestone	— — — — —	Mine tramways
			— — — — —	Elevated tramways
			x x x x x	Trenches
			o	Shafts
			x	Prospects
			1200 1100	Contours (showing land forms and elevations above sea-level)
			▨ ▨ ▨ ▨	Mine dumps
				Approximate magnetic declination, 10° 20' West.

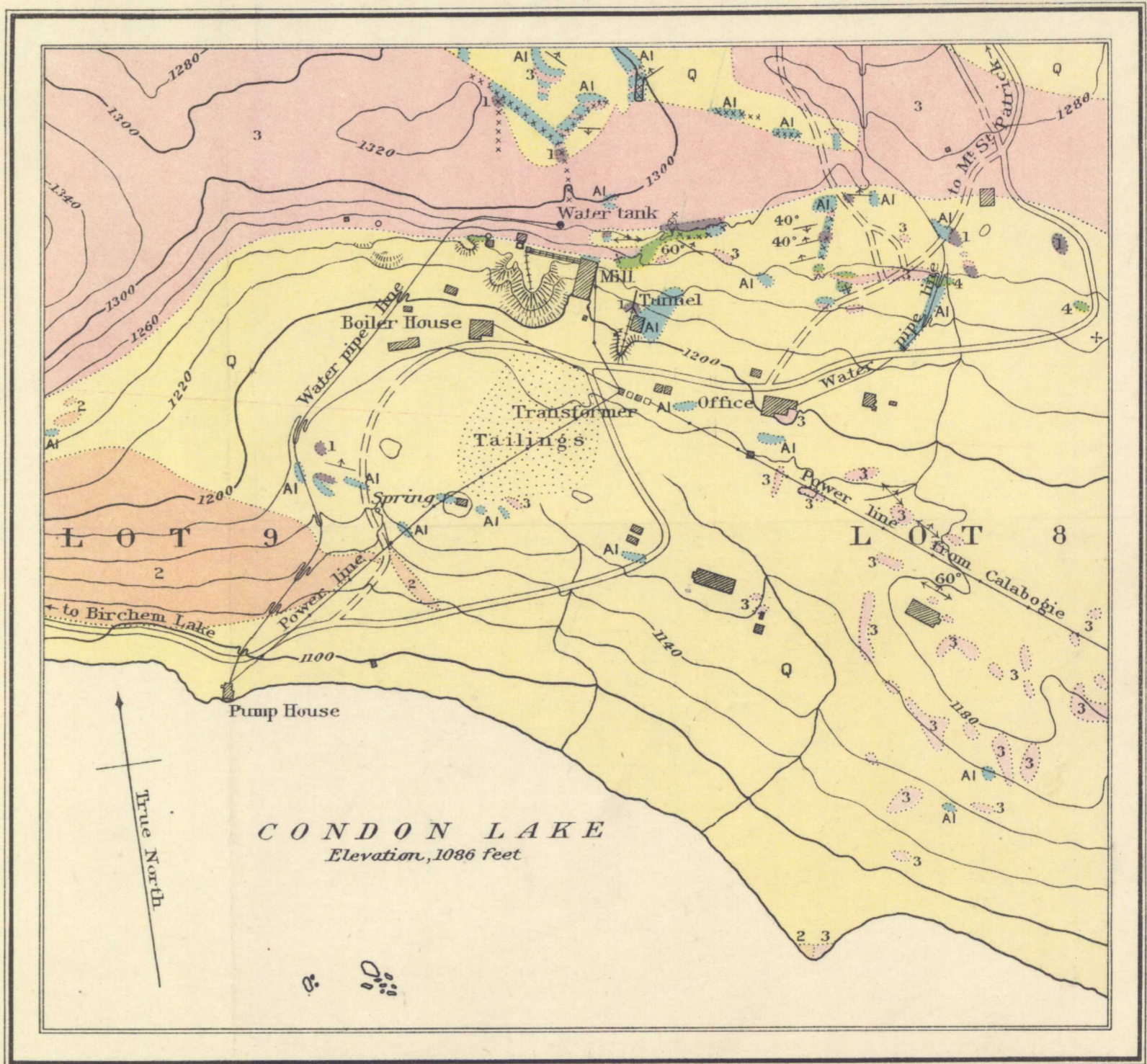

C.O. Senécal, Geographer and Chief Draughtsman.
A.M. Greer, Draughtsman.

Publication N° 1800

MOLYBDENITE DEPOSITS, LOTS 8 AND 9, CONCESSION XI, BROUGHAM TOWNSHIP, RENFREW COUNTY, ONTARIO.

Scale of Feet
0 100 200 300 400 500

NOT TO BE TAKEN FROM LIBRARY
NE PAS S'OPPRIMER DE LA BIBLIOTHÈQUE
Sources of Information
Geology by M. E. Wilson, 1919.
Topography by C. H. Freeman, 1919.

1800

Renfrew Co.
(Brougham tp.)

5.1.7
A, Geol.

To accompany Summary Report, Part E, 1919,
and Memoir by M. E. Wilson.