

Canada Department of Mines

HON. SIR. JAMES A. LOUGHEED, MINISTER., CHARLES CAMSELL, ACTING DEPUTY MINISTER.

GEOLOGICAL SURVEY
WILLIAM Mc INNES, DIRECTOR.

Issued 1920

LEGEND

EARLY PRECAMBRIAN

- 3
Granite gneiss
- 2
Outcrop of pyrite ore bodies
- 1
Hornblende schist or hornblende biotite schist

Symbols

- Geological boundary
- Dip and strike, banding and foliation
- Vertical banding and foliation
- Direction and dip of diamond-drill hole
- Roads and buildings
- Roads (not well defined)
- Mine tramways
- Pits and trenches
- Diamond-drill holes
- Contours (showing land forms and elevations above sea-level)
- Mine dumps

Approximate magnetic declination, 10° 30' West.

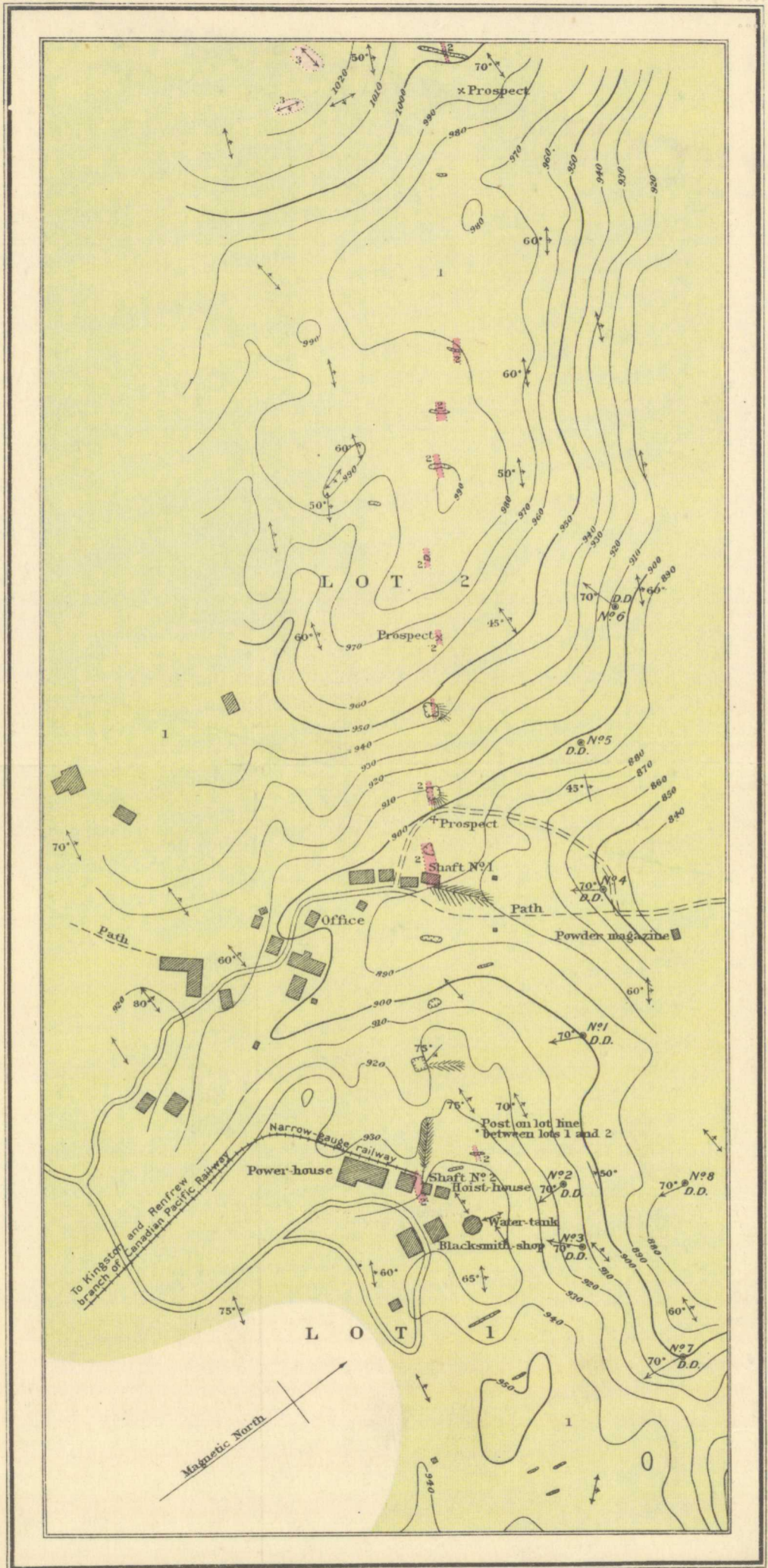

C.O. Senécal, Geographer and Chief Draughtsman.
A.M. Greer, Draughtsman.

Publication No 1798

PYRITE DEPOSITS (OUTCROPS), LOTS 1 AND 2, CONCESSION 1,
BLITHFIELD TOWNSHIP, RENFREW COUNTY, ONTARIO.

Scale of Feet
100 50 0 100 200 300

Sources of Information
Geology by M.E. Wilson, 1919.
Topography by Grasselli Chemical Company, with additions by M.E. Wilson.

Renfrew Co.

To accompany Summary Report, Part E, 1919,
and Memoir by M.E. Wilson.

5-1-7
A. Geol.

NOT TO BE TAKEN FROM THE LIBRARY
DE LA BIBLIOTHÈQUE

1798